

PRIMING AND LOADING THE DISPOSABLE SET

THESE INSTRUCTIONS ARE NOT A SUBSTITUTE FOR THE OPERATOR'S MANUAL

Be sure to read the operator's manual thoroughly prior to operating the pump. See other side for pump operation instructions.

STEP 1

Remove cap on Infinity Orange 100 mL disposable set. Hold bag upright and pour in feeding solution. Close cap securely. NOTE: If you are using the EnteraLite Infinity 500 mL or 1200 mL disposable set, follow the same instructions.



STEP 2

Remove protective cover from the distal end connector.

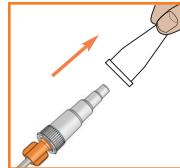

STEP 3 - PRIMING

IF PUMP PRIMING

Loop silicone tubing around pump wheel stretching lightly.

Seat cassette into pump. Close pump door. Press and hold **ON/OFF** key for 1.5 seconds to turn pump on.

Press and hold the **PRIME** key until formula reaches the distal end connector.

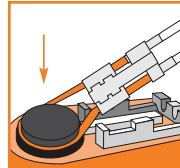

IF MANUAL PRIMING

Gently pinch orange colored tubing below the "Δ" symbol and squeeze bag at the same time to assist fluid flow.

Hold this position until formula reaches the distal end connector.

Loop silicone tubing around pump wheel stretching lightly.

Seat cassette into pump. Close pump door.

For backpack use: Turn bag upside down and gently squeeze. Tilt bag as needed to keep air at tubing port. At the same time, gently pinch orange colored tubing below the "Δ" symbol. Hold this position until air is removed from the tubing. Gently squeeze bag at the same time to assist fluid flow.

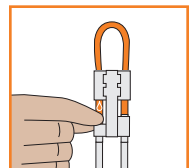
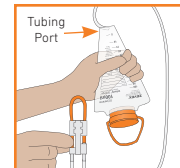
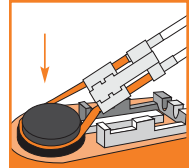
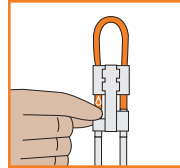

PROGRAMMING AND RUNNING THE PUMP

THESE INSTRUCTIONS ARE NOT A SUBSTITUTE FOR THE OPERATOR'S MANUAL

Be sure to read the operator's manual thoroughly prior to operating the pump. See other side for delivery set priming and loading instructions.

STEP 1

Hang feeding container so that the bottom of the bag is at or above the level of the pump door.

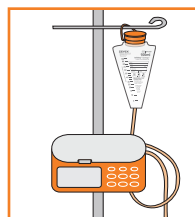

STEP 2

Press and hold **ON/OFF** key for 1.5 seconds to turn pump on. After running the self test, display will show last programmed rate.

ON/OFF



STEP 3

Program the prescribed rate using the **(+)** and **(-)** keys.

+



-



STEP 4

Press **RATE/DOSE** key to display dose. Program the prescribed dose using the **(+)** and **(-)** keys.

RATE/DOSE



+



-



STEP 5

Press the **FOOD TYPE** key to display type of food to be delivered. Press the **(+)** and **(-)** keys to change between formula and human milk.

FOOD TYPE



CLEAR



STEP 6

Insert stepped connector into patient's feeding tube.

- ▶ For a feeding tube without the ENFit® connection system, use pre-attached transitional connector to connect set to the feeding tube. Note: If transitional connector has become detached from the set or is loose, screw it clockwise onto the set firmly by hand. Be careful not to overtighten.
- ▶ For a feeding tube with the ENFit® connection system, remove pre-attached transitional connector from set and screw set clockwise into feeding tube firmly by hand. Be careful not to overtighten.

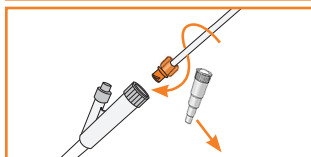
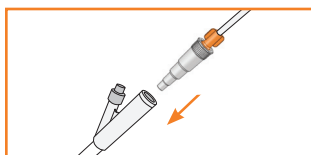

STEP 7

Press **RUN/PAUSE** key to start the pump.

RUN/PAUSE



STEP 8

When feeding is complete, press **ON/OFF** key for 1.5 seconds to turn the pump off.

ON/OFF



NOTE: User must confirm each parameter (rate, dose, and food type) before pump will start. If dose and food type are viewed prior to pressing the **RUN/ PAUSE** key, pump will alarm and display CON FIRM DOSE AND FOOD TYPE.

NOTE: Rate, dose, and food type settings can be locked so that changes cannot be made. See the User Preference Settings section of the Infinity Orange Operator's Manual for additional information.